



Rangjung Yeshe Gomde Trust



*The Hermitage Lhakang*

## Hardmuir Woodland Hermitage, Scotland, UK

### An Auspicious Opportunity to Help Build the Retreat Houses!

The Gomde Hermitage is set in 21 acres of beautiful, secluded broadleaf woodland near Inverness and Findhorn, an area known for its good weather, clear skies and varied countryside. It was offered to Rangjung Yeshe Gomde Trust for people to practice meditation in simplicity, peace and solitude.

Now you can help it blossom into a peaceful and harmonious sanctuary for practitioners, as we have the rare opportunity to build eco friendly, low impact retreat houses. The aim is to create a unique dedicated retreat space, in secluded log cabins with the wide-open views that are perfect for enhancing meditation practice.

Now that we have this opportunity, it would be lovely to first offer our Precious Teachers a retreat house. The auspicious connection brings the blessing of the practice lineages of Kagyü and Nyingma closer to our hearts.

*“Greater than making offerings of flowers, incense, food  
And every pleasing thing to the Buddhas for an entire Kalpa;  
Is to take seven steps in the direction of a solitary place,  
With a mind that is weary of samsara.  
The merit of such an act is unbounded”*

This is also a chance to join in sponsoring a log cabin for your own retreat and for others also to be able to practice meditation in this natural and beautiful environment.

Even if we don't have much time to practice now, making the offering of a retreat house will create merit and circumstances to be able to practice in retreat in the future. It will support practitioners now and you will make almost the same merit as the retreatants who practice there.

The Woodland Hermitage, Hardmuir of Boath, Auldearn, Nairnshire, Scotland. IV12 5QG  
A Charity Registered in Scotland Number SC040361



## Rangjung Yeshe Gomde Trust



If all goes well, then in the spring of 2010 we hope to be able to start building the first log cabins. An auspicious place to start is the retreat houses for our Teachers, which makes a link between the generosity of the donors, the blessing of the retreat place and the practice and realisation of the lineage masters.

### Kyabje Trulshik Rinpoche's Wooden Retreat Hut.

Kyabje Trulshik Rinpoche recognised and enthroned the reincarnation of Tulku Urgyen Rinpoche. His *Mo* or divination about the land was very good and he has repeatedly said it is an excellent place for retreat. He has often spoken of his love of small wooden retreat huts and has already chosen the design for a log cabin at Hardmuir. It is very cute little hut based on the traditional dimensions mentioned in the scriptures, therefore nestled in the trees nearby we need to build a small separate bathroom and kitchen. To create a very auspicious connection, please join in to help sponsor this retreat hut for Kyabje Trulshik Rinpoche.

### Chökyi Nyima Rinpoche's Retreat House.

Chökyi Nyima Rinpoche very much hopes to come and visit in summer 2010. This is the chance to help sponsor Chökyi Nyima Rinpoche's log cabin where he will stay when he visits. This will also be where Chökling Rinpoche, Phakchok Rinpoche and any other visiting Rinpoche would reside. It is a great blessing to help provide a retreat place for the Lamas. Please help make this a comfortable and beautiful place for Rinpoche. A log cabin made with 56mm thick timber with shrine room, kitchenette and bathroom, insulation and solar electricity will create a perfect retreat space for Rinpoche. To donate, please use the bank details below or for small amounts click on the Paypal donate buttons.

Donate



**Bank Details:** Rangjung Yeshe Gomde Trust, Bank of Scotland, 102 High Street, Forres, IV36 2OP. Account No. 06020261. Sort Code: 80 06 81. **BIC:** BOFSGB21290. **IBAN:** GB90 BOFS 8006 8106 0202 61.

The Woodland Hermitage, Hardmuir of Boath, Auldearn, Nairnshire, Scotland. IM2 5QG  
A Charity Registered in Scotland Number SC040361



## Rangjung Yeshe Gomde Trust



*possible designs for log cabins*

### Retreat Houses at the Hermitage

The main purpose of this programme is to create the accommodation needed for people to benefit from staying at the Hermitage to practice retreat in a beautiful and blessed place.

The log cabins will be sturdy, (56mm wood logs – double tongue and groove), warm and low maintenance. All will be completely self-sufficient, with kitchen (sink, calor gas cooker and refrigerator) and bathroom (hot shower, sink and toilet). Each house will be connected to mains drinking water and will have insulation in the roof and the floor, double-glazing, its own solar electricity system and a wooden heating stove.

The single huts will consist of three rooms: shrine and sleeping space plus small kitchen and bathroom and a veranda. The double log cabins will have two separate meditation rooms, plus an extra room, shared living room with galley kitchen, bathroom and veranda. All houses will have shutters and attached storeroom.

The cabins are self-catering and there will be a charge for utilities for all those in residence. Advance booking will be necessary, as the retreat houses will be made available for other practitioners to use when not being used by a Patron or Sponsor. This will help generate immense merit by creating the circumstances for other people to stay and practice.



As we are obliged to adhere to local building and planning regulations governing the size, height and construction methods and materials of the buildings, individual self builds will not be possible. The final design of the huts will have to be approved by Chökyi Nyima Rinpoche.

There are different ways contribute: as a **Friend**, **Patron** or a **Retreat House Sponsor**. The hermitage will be run as a retreat cooperative, maintaining a peaceful, harmonious and sacred atmosphere.

### Friends of the Hermitage

The Tibetans have an old saying; “many small drops can fill a vast ocean” If you would like to make a connection to the project through an auspicious offering, click here:



The Woodland Hermitage, Hardmuir of Boath, Auldearn, Nairnshire, Scotland. IV12 5QG  
A Charity Registered in Scotland Number SC040361



## Rangjung Yeshe Gomde Trust



*possible design for log cabin*

### Patrons of the Hermitage

Patrons are a group of dedicated supporters who wish to be more closely associated with the Hermitage and make a vital contribution to its development. Becoming a Patron also helps to subsidise retreat facilities, so we are able to keep prices really minimal for other retreatants.

Benefits of being a Patron:

- Two weeks a year free accommodation for your personal retreat.
- Special discounted rates thereafter
- Priority booking for any events or teachings
- Preferential choice of retreat house
- Kept informed of development through newsletters
- Name included in the annual prayer ceremony
- Invited to join the annual Trustee meeting and dinner
- Name written at a symbolic Tree of Support at Hardmuir

To become an Individual Patron requires a minimum donation of £300 a year, or just £25 per month if you wish to pay by Direct Debit. For Joint Patrons the minimum donation is £500 annually or £40 per month by Direct Debit.

Life Patronage or Joint Life Patronage, for donations of £5,000 or £8,000 respectively, will allow ongoing involvement with our work, while providing funds to help us plan for the future. To donate please use the bank details below, or for small amounts click on the Paypal donate buttons.

[Donate](#)



**Bank Details:** Rangjung Yeshe Gomde Trust, Bank of Scotland, 102 High Street, Forres, IV36 2OP. Account No. 06020261. Sort Code: 80 06 81. **BIC:** BOFSGB21290. **IBAN:** GB90 BOFS 8006 8106 0202 61.

For further information, please contact us at [hermitage@gomde.org.uk](mailto:hermitage@gomde.org.uk)

The Woodland Hermitage, Hardmuir of Boath, Auldearn, Nairnshire, Scotland. IV12 5QG  
A Charity Registered in Scotland Number SC040361



## Rangjung Yeshe Gomde Trust

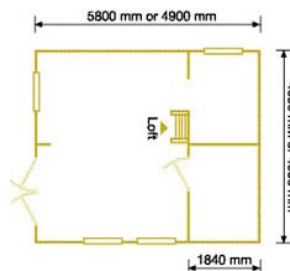

*possible design for log cabin*

### Retreat House Sponsors

With the permission of the authorities there is now the rare opportunity to sponsor single or double retreat houses and we can build places for 8 retreatants. If you are in a position to be able to wholly sponsor a log cabin for retreat, then your generosity will help lay the foundations and set the conditions for yourself and generations of practitioners to deepen there understanding of the path though meditation practice.

*For further information about full sponsorship, please contact us at [hermitage@gomde.org.uk](mailto:hermitage@gomde.org.uk)*

However, as most people do not have the means for this we are forming an informal retreat cooperative sponsorship programme. For donations of £9,000 for single retreat house or £15,000 for double retreat house respectively, you will have a lifelong investment in the retreat huts. You will have unlimited, priority use subject to reasonable availability and advanced booking. One month per year will be free accommodation for a single or a double cabin respectively and after that special discounted rates will apply. Sponsorship must be received by Feb 2010 for any log cabin to be built this summer.

Retreat House Sponsors will automatically enjoy the related facilities and opportunities of Patrons including:

- One month a year free accommodation for your personal retreat.
- Unlimited stay at special discounted rates thereafter
- Priority booking for any events or teachings
- Preferential choice of retreat house
- Kept informed of development through newsletters
- Name included in the annual prayer ceremony
- Invited to join the annual Trustee meeting and dinner
- Name written at a symbolic Tree of Support at Hardmuir

Donate



**Bank Details:** Rangjung Yeshe Gomde Trust, Bank of Scotland, 102 High Street, Forres, IV36 2OP. Account No. 06020261. Sort Code: 80 06 81. **BIC:** BOFSGB21290. **IBAN:** GB90 BOFS 8006 8106 0202 61.

*For further information, please contact us at [hermitage@gomde.org.uk](mailto:hermitage@gomde.org.uk)*

The Woodland Hermitage, Hardmuir of Boath, Auldearn, Nairnshire, Scotland. IV12 5QG  
A Charity Registered in Scotland Number SC040361